

CREATE YOUR SANCTUARY STYLE

# Secret Garden Cushion



SWAROVSKI



# Secret Garden Cushion



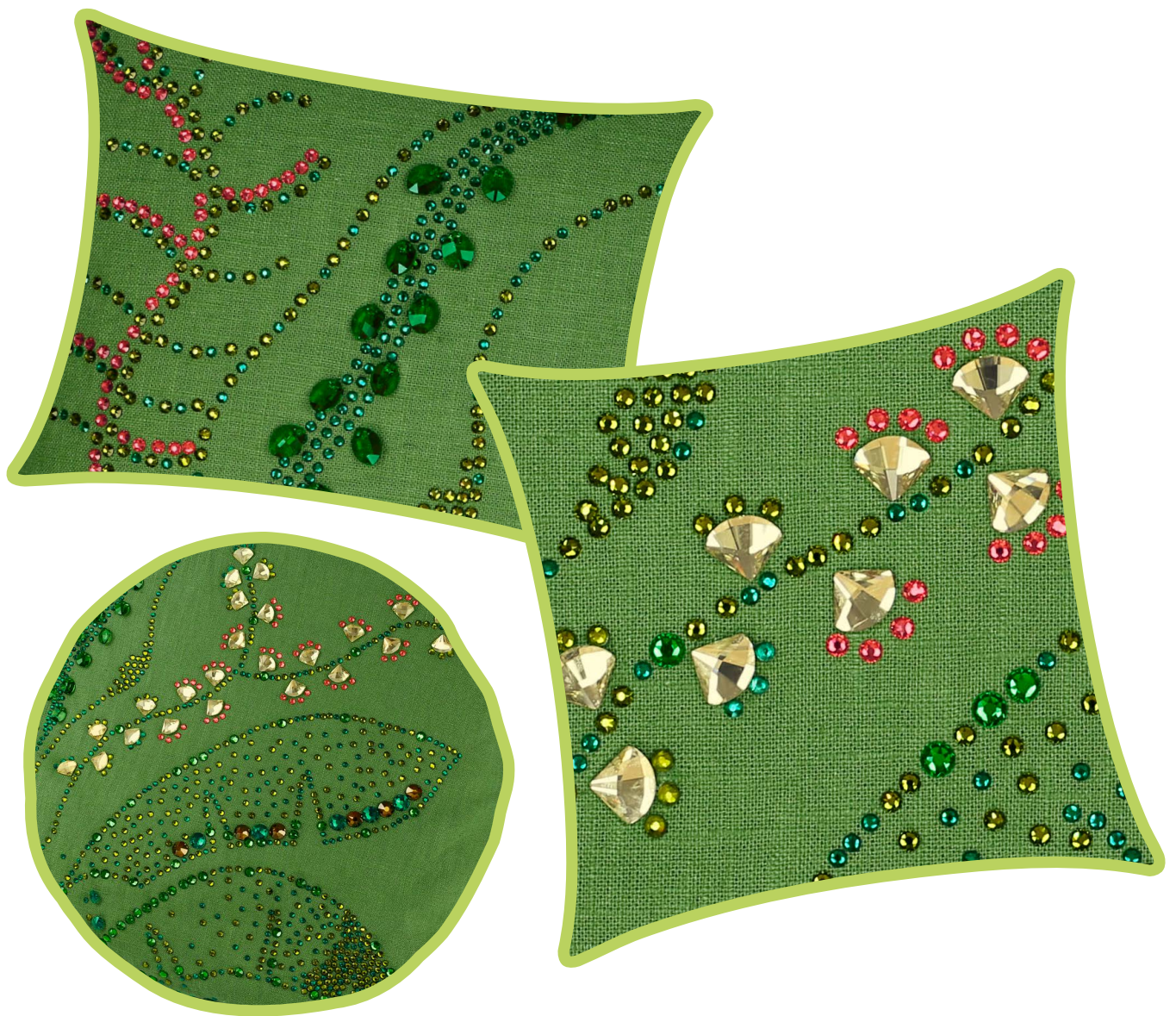





Try combining the Secret Garden Cushion with others that have different patterns. It will look great alongside florals, animal prints and stripes on a sofa or a bed.



# Get Ready!

To create these pieces you'll need the following products:

## Swarovski crystals you need





Product	Art. No.	Quantity	Size	Color (Code)
 Xirius Rose Hotfix	2078	160	SS20	Padparadscha (542)
 Xirius Rose Hotfix	2078	500	SS20	Olivine (228)
 Xirius Rose Hotfix	2078	500	SS16	Emerald (205)
 Xirius Rose Hotfix	2078	150	SS34	Fern Green (291)
 Fan FB Hotfix	2714	26	14 mm	Jonquil (213)
 Pure Leaf Pendant	6734	5	14 mm	Fern Green (291)
 Clover Crystal Button	3011	14	10 mm	Emerald (205)
 Xirius Sew-on Stone	3288	6	12 mm	Iridescent Green (IRIG)
 Xirius Sew-on Stone	3288	6	12 mm	Emerald (205)

## Other products you need

Product	Quantity	Size	Color
Cushion	1	-	Green
Chalk	1	-	-
Teflon	1	-	-

## Tools



Time	Level	Style	Budget
 A few hours	 Beginners	 Modern	 Expensive

# Step-by-step Instructions

01

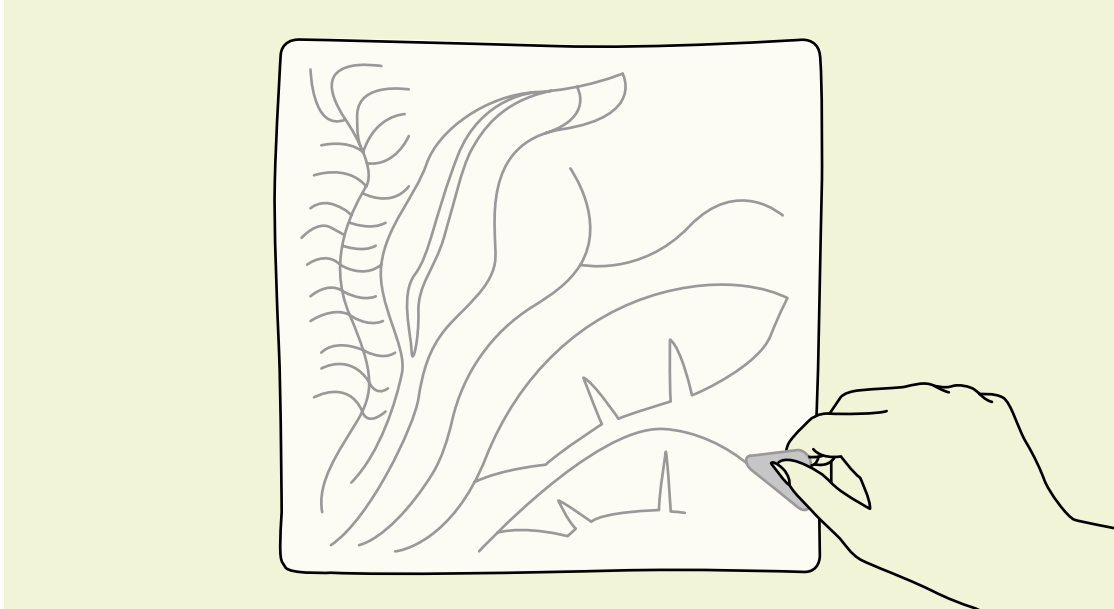

Copy this image (or another image that inspires you). Now remove the padding from the cushion so that you can work on the flat surface of the cushion cover. Using chalk, copy an outline of the image onto the cover.

02

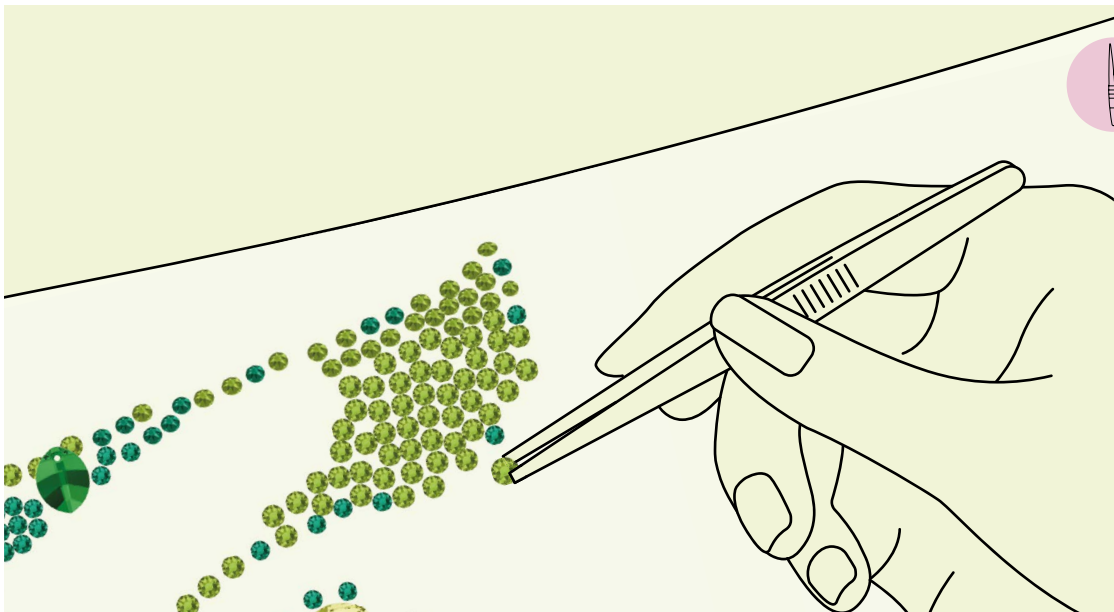

Using tweezers, place **Xirius Rose Hotfix** crystals along the chalk outline, alternating the two shades of green (Olive and Emerald) and including a few Fern Green on some of the leaves.

# Step-by-step Instructions

03

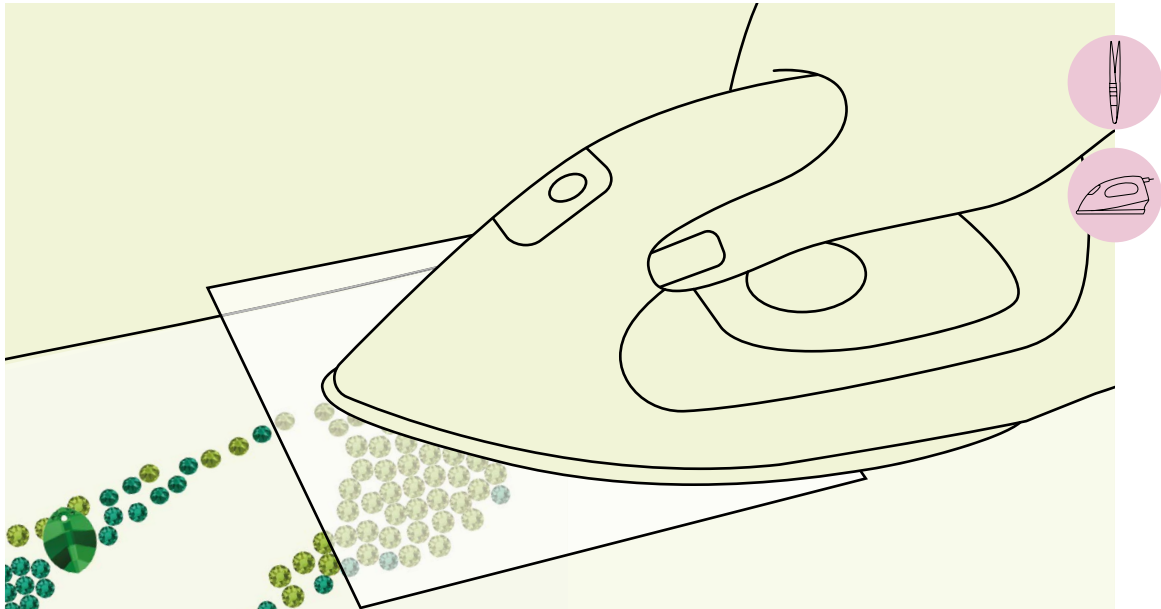

Place the Teflon sheet carefully on top of the crystals and iron it.

04

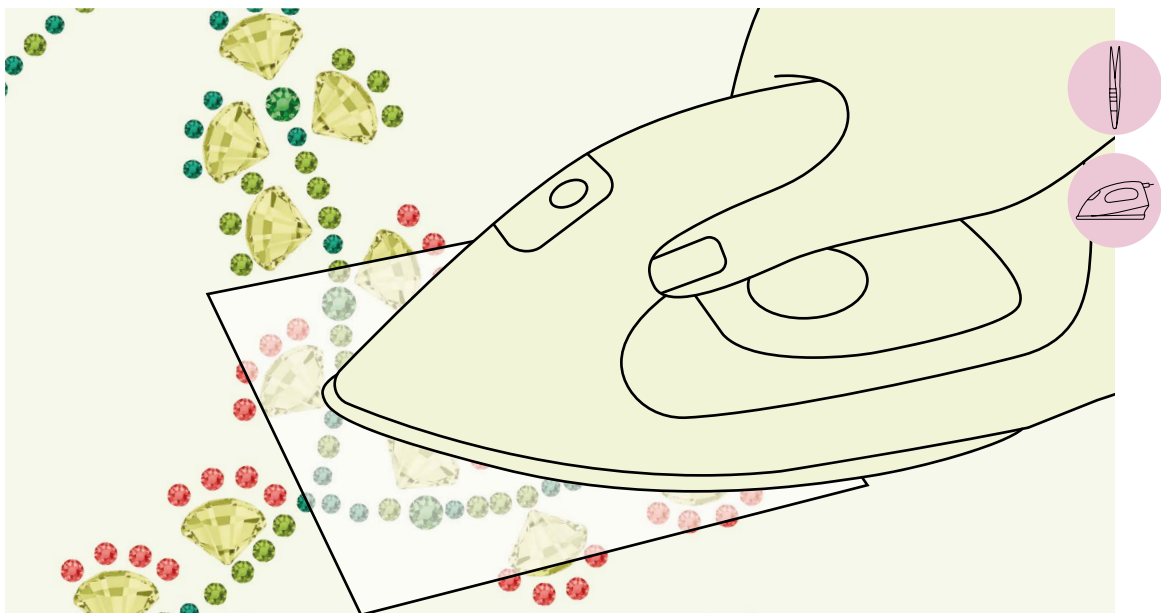

Continue placing the **Hotfix crystals** along the outline. Do this stage by stage, covering with Teflon and ironing to secure them in position before moving on to the next part of the design.

# Step-by-step Instructions

05

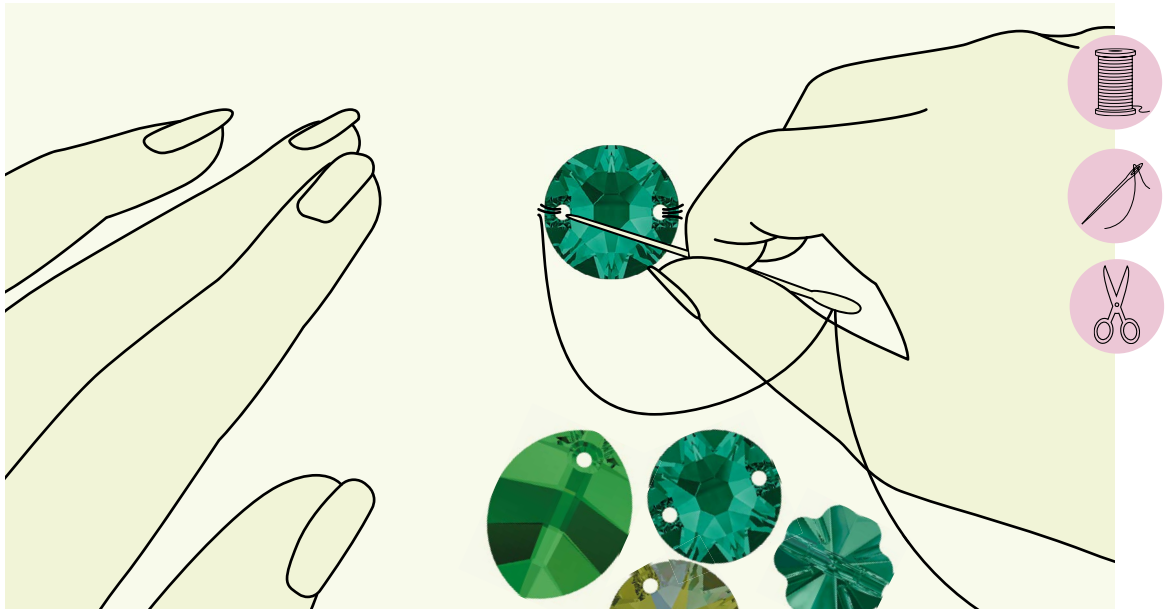

Sew the **Pure Leaf Pendants** onto the inside of one leaf; then sew the **Xirius Sew-on Stones** onto the inside of another leaf, alternating the two shades of green. Now sew the **Clover Crystal button** randomly onto a corner of the cushion.

06

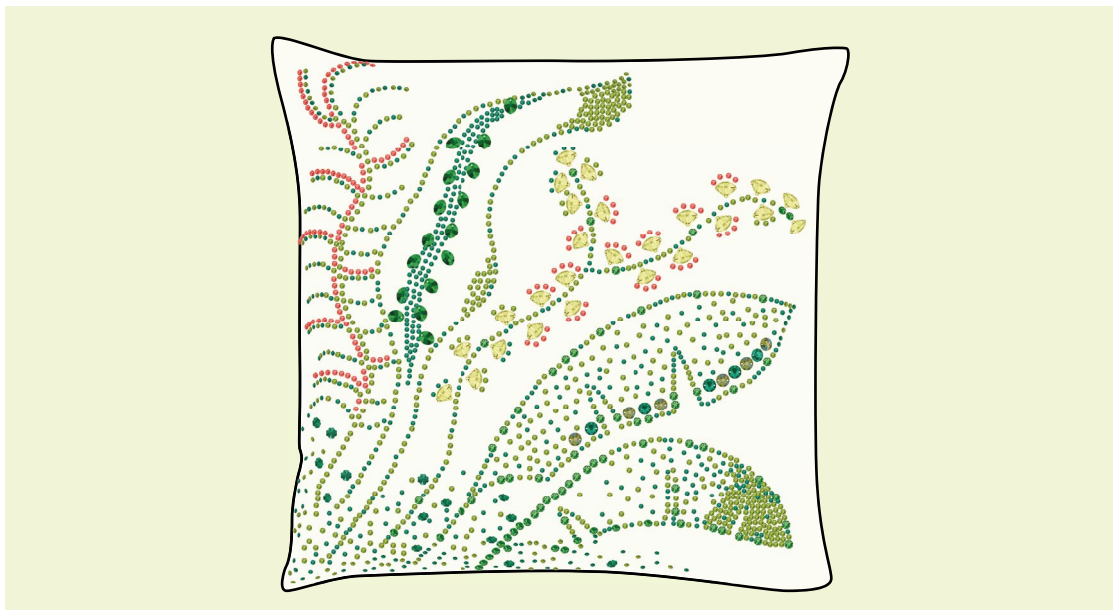

Bring the garden indoors with sparkling lush, green leaves.



You'll find this, along with many other inspiring projects, on our website:  
[CREATE-YOUR-STYLE.COM](http://CREATE-YOUR-STYLE.COM)



SWAROVSKI